

ANTHONY JAMES MANSEY

Residential Sales & Lettings



Linkfield Road

Isleworth, TW7 6QJ

£625,000

Freehold

Council Tax Band D

On the highly sought-after Linkfield Road in Isleworth, this charming semi-detached house presents an excellent opportunity for families and professionals alike. With three bedrooms and family bathroom and downstairs WC. Upon entering the ground floor, you will find a spacious double reception, this property has also been freshly painted throughout, creating a bright and welcoming atmosphere. The kitchen / diner is ready for your personal touch, with a sink and unit already in place, allowing you to install your preferred kitchen design. From here, you can step out into a generous garden. The first floor comprises three inviting bedrooms, complemented by a family bathroom that has been recently updated. This property has an up-to-date Electrical Installation Condition Report (EICR) for peace of mind. Situated in the heart of the community, this home is surrounded by a variety of local shops and cafes. Additionally, the area benefits from a regular hopper bus service to Richmond and St Margaret's, while Isleworth Station provides convenient access to Waterloo, perfect for commuters. Off-street parking adds to the appeal of this delightful property.

Viewing

Please contact our Sales Office on 020 8847 0488 if you wish to arrange a viewing appointment for this property or require further information.

- A Period Three Bedroom Semi Detached House
- Through Lounge Reception Room
- Kitchen and Separate Dining Area
- Downstairs Cloakroom with WC
- Three Bedrooms
- First Floor Family Bathroom
- Front Garden with Off Street parking
- Good Size Rear Garden
- Close to St Johns Gardens, Local Shops and Cafes
- Isleworth Station Serving Waterloo



3



2



1



D

Floor Plan

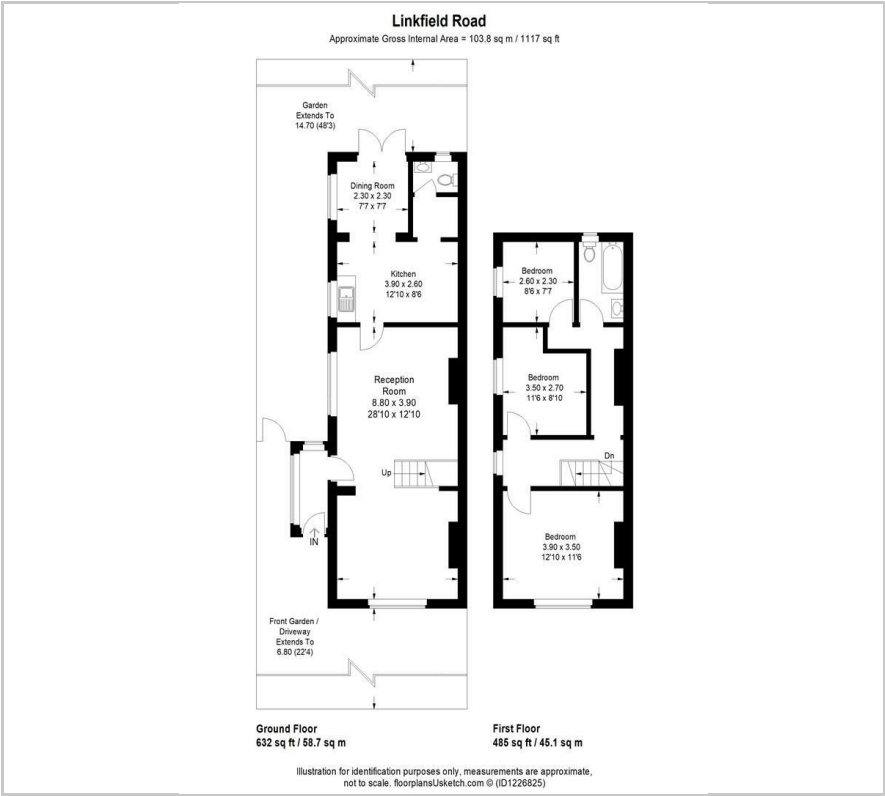

Area Map



Energy Efficiency Graph

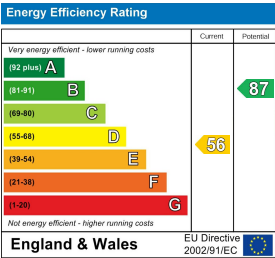

These particulars, whilst believed to be accurate are set out as a general outline only for guidance and do not constitute any part of an offer or contract. Intending purchasers should not rely on them as statements of representation of fact, but must satisfy themselves by inspection or otherwise as to their accuracy. No person in this firms employment has the authority to make or give any representation or warranty in respect of the property.